

R1 MR1 MR1 MR1 MR1 M

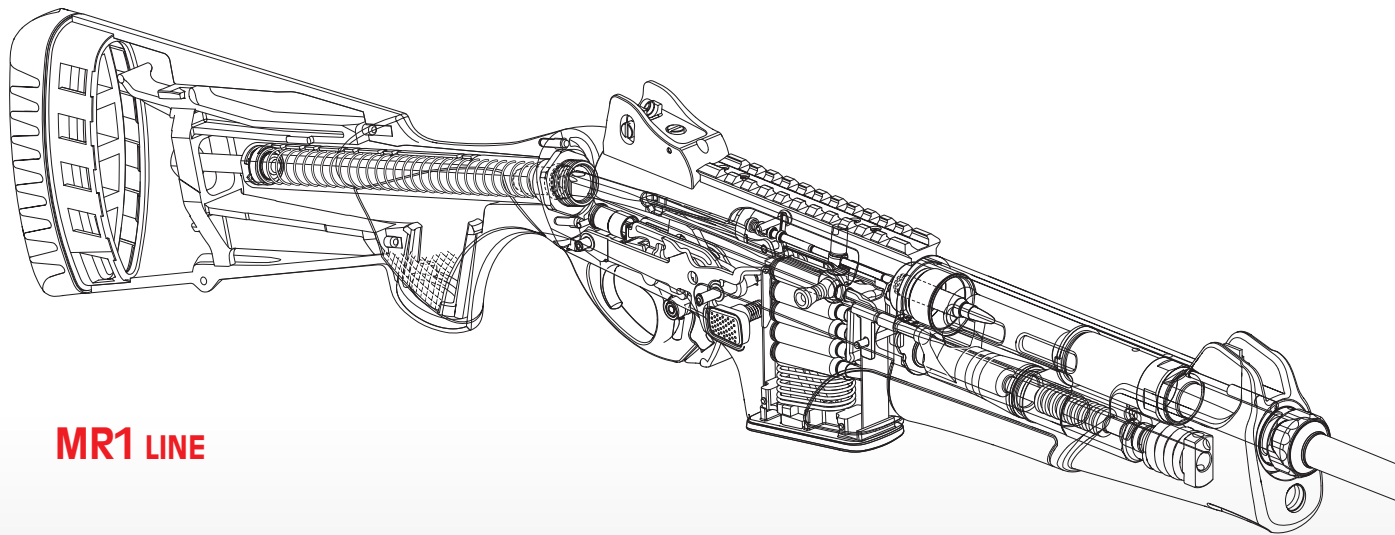



MR1 LINE

 **Benelli**



Index

USE • MAINTENANCE	1	Stock disassembly and assembly	16
Basic safety rules	2	Stock disassembly	16
Introduction	4	Stock assembly	19
Operation	4	Troubleshooting	21
Assembly	5	Choice of ammunition	21
Use	7	Rear sight adjustment	22
Rifle safety catch	7	Windage adjustment	22
Loading	8	Elevation adjustment	22
Unloading procedure	9	SPARE PARTS	23
Stripping of the rifle	9		
Maintenance	12		
Rifle assembly	13		





BASIC SAFETY RULES

WARNING: PLEASE READ THIS MANUAL BEFORE HANDLING YOUR FIREARM.

WARNING: FIREARMS CAN BE DANGEROUS AND CAN POTENTIALLY CAUSE SERIOUS INJURY, DAMAGE TO PROPERTY OR DEATH, IF HANDLED IMPROPERLY. THE FOLLOWING SAFETY RULES ARE AN IMPORTANT REMINDER THAT FIREARM SAFETY IS YOUR RESPONSIBILITY.

1. NEVER POINT A FIREARM AT SOMETHING THAT IS NOT SAFE TO SHOOT.

Never let the muzzle of a firearm point at any part of your body or at another person. This is especially important when loading or unloading the firearm. When you are shooting at a target, know what is behind it. Some bullets can travel over a mile. If you miss your target or if the bullet penetrates the target, it is your responsibility to ensure that the shot does not cause unintended injury or damage.



2. ALWAYS TREAT A FIREARM AS IF IT WERE LOADED.

Never assume that a firearm is unloaded. The only certain way to ensure that a firearm has the chamber empty is to open the chamber and visually and physically examine the inside to see if a round is present. Removing or unloading the magazine will not

guarantee that a firearm is unloaded or cannot fire. Shotguns and rifles can be checked by removing all rounds and by then opening and inspecting the chamber so that a visual inspection of the chamber for any remaining rounds can be made.

3. STORE YOUR FIREARM SO THAT CHILDREN CANNOT GAIN ACCESS TO IT.

It is your responsibility to ensure that children under the age of 18 or other unauthorized persons do not gain access to your firearm. To reduce the risk of accidents involving children, unload your firearm, lock it and store the ammunition in a separate locked location. Please note that devices intended to prevent accidents - for example, cable locks, chamber plugs, etc., - may not prevent use or misuse of your firearm by a determined person. Firearm storage in a steel gun safe may be more appropriate to reduce the likelihood of intentional misuse of a firearm by an unauthorized child or person.

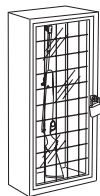

4. NEVER SHOOT AT WATER OR AT A HARD SURFACE.

Shooting at the surface of water or at a rock or other hard surface increases the chance of ricochets or fragmentation of the bullet or shot, which can result in the projectile striking an unintended or peripheral target.



5. KNOW THE SAFETY FEATURES OF THE FIREARM YOU ARE USING, BUT REMEMBER: SAFETY DEVICES ARE NOT A SUBSTITUTE FOR SAFE HANDLING PROCEDURES.

Never rely solely on a safety device to prevent an accident. It is imperative that you know and use the safety features of the particular firearm you are handling, but accidents can best be prevented by following the safe handling procedures described in these safety rules and elsewhere in the product manual.

To further familiarize yourself with the proper use of this or other firearms, take a Firearms Safety Course taught by an expert in firearms use and safety procedures.

6. PROPERLY MAINTAIN YOUR FIREARM.

Store and carry your firearm so that dirt or lint does not accumulate in the working parts. Clean and oil your firearm, following the instructions provided in this manual, after each use to prevent corrosion, damage to the barrel or accumulation of impurities which can prevent use of the gun in an emergency. Before loading your firearm, always check the barrel internal part and the chamber to ensure that they are clean and free from obstructions. Firing with an obstruction in the barrel or chamber can rupture the barrel and injure you or others nearby. In the event you hear an unusual noise when shooting, stop firing immediately, engage the manual safety and unload the firearm.



Make sure the chamber and barrel are free from any obstruction, like a bullet blocked inside the barrel due to defective or improper ammunition.

7. USE PROPER AMMUNITION.

Only use factory-loaded, new ammunition manufactured to industry specifications: CIP (Europe and elsewhere), SAAMI® (U.S.A.). Be certain that each round you use is in the proper caliber or gauge and type for the particular firearm.

The caliber or gauge of the firearm is clearly marked on the barrels of shotguns and on the slide or barrel of pistols.

The use of reloaded or remanufactured ammunition can increase the likelihood of excessive cartridge pressures, case-head ruptures or other defects in the ammunition that can cause damage to your firearm and injury to yourself or others nearby.

8. ALWAYS WEAR PROTECTIVE GLASSES AND EARPLUGS WHEN SHOOTING.

The chance that gas, gunpowder or metal fragments will blow back and injure a shooter who is firing a gun is rare, but the injury that can be sustained in such circumstances can be severe, including the possible loss of eyesight. A shooter must always wear impact resistant shooting glasses when firing any firearm. Earplugs or other high-quality hearing protectors help reduce the chance of hearing damage from shooting.



9. NEVER CLIMB A TREE, FENCE OR OBSTRUCTION WITH A LOADED FIREARM.

Open and empty the chamber of your firearm and engage the manual safety catch before climbing or descending a tree or before climbing a fence or jumping over a ditch or other obstruction. Never pull or push a loaded firearm toward yourself or another person. Always unload the firearm, visually and physically check to see that the magazine, loading mechanism and chamber are unloaded and that the bolt is open before handing the firearm to another person. Never take a firearm from another person unless it is unloaded, visually and physically checked to confirm it is unloaded, and the action is open.



10. AVOID ALCOHOLIC BEVERAGES OR JUDGMENT/ REFLEX IMPAIRING MEDICATION WHEN SHOOTING.

Do not drink and shoot. If you take medication that can impair motor reactions or judgment, do not handle a firearm while you are under the influence of the medication.



11. NEVER TRANSPORT A LOADED FIREARM.

Unload a firearm before putting it in a vehicle (chamber empty, magazine empty). Hunters and target shooters should load their firearm only at their destination, and only when they are ready to shoot. If you carry a firearm for self-pro-



tection, leaving the chamber unloaded can reduce the chance of an unintentional discharge.

12. LEAD WARNING.

Discharging firearms in poorly ventilated areas, cleaning firearms, or handling ammunition may result in exposure to lead and other substances known to cause birth defects, reproductive harm, and other serious physical injury. Have adequate ventilation at all times. Wash hands thoroughly after exposure.

WARNING: it is YOUR responsibility to know and abide by Federal, State and Local laws governing the sale, transportation and use of firearms in your area.

WARNING: this firearm has the capability of taking your life or the life of someone else! Always be extremely careful with your firearm. An accident is almost always the result of not following basic firearm safety rules.

Especially for U.S. consumers:

For information about Firearm Safety Courses in your area, please visit the National Rifle Association's web site at www.nra.org.





Introduction

Benelli Armi S.p.A. proudly presents the new MR1 line of semi-automatic rifles, that are the result of Benelli's Research and Development Centre's operational efficiency, added to Benelli's extensive technical experience and skilled constructional engineering.

The reduced number of components plus the extremely simplified and rational design provide highly reliable operational performances. The new rifles are practical to use and easy to strip and service, to the extent that they have every right be considered as being the most innovative, accurate, safe, fast and stylish weapons of their kind available now on the market.

Operation

Before beginning any operation whatsoever on your rifle, always make sure that chamber and magazine have been completely emptied!

(Carefully read loading and unloading instructions).

MR1 rifles are fitted with a prismatic magazine; their semi-automatic operation is based upon the patented **Benelli ARGO** (Auto Regulating Gas Operated) system, featuring a revolving bolt head built with three locking teeth that perfectly close the breech axially.

We can divide the weapon's operational system into 8 specific actions:

- firing** once the trigger is pulled the hammer is set off and the impact with the firing pin fires up the cartridge in the chamber. The gasses that are given off by the reaction shoot the shell out of the barrel and simultaneously expand into the gas collector cylinder, thus causing immediate retraction on behalf of the piston with subsequent bolt retraction. This consequently leads to the
- clearing** of the chamber, which is opened and made ready for subsequent
- extraction** which entails removal of the cartridge case from the chamber, and

ejection whereby the cartridge case is definitely ejected out of the rifle. In the final phases of the out motion the mechanism gets ready for

reloading which in synthesis can also be considered as being "energy storage" for the next shot. Separate devices simultaneously provide

introduction which entails automatic exit of a new cartridge from the magazine and subsequent

positioning of the cartridge into the firing chamber, followed by

clamping i.e. air-tight sealing of the chamber.

The rifle is now ready to shoot.

Assembly (from packaged rifle)

Pieces contained in the package (fig. 1):

- a) **stock-receiver-fore-end** unit
- b) **barrel-bolt** unit

Assembly procedure

- 1) Slide the **fore-end** out (fig. 2).
- 2) Hold the **stock-receiver-fore-end** unit with one hand and with the other, unscrew the **barrel locking cap** (fig. 3).
- 3) Make sure **hammer** is cocked and if not, do so (fig. 4).
- 4) Unscrew the **fore-end cap** on the **barrel-bolt** unit (fig. 5).
- 5) Hold the **stock-receiver-fore-end** unit with one hand and the **barrel-bolt** unit with the other. Slide the **gas collector cylinder** onto the cylinder guide pin (fig. 6) at the same time **sliding the bolt backwards** (fig. 7).

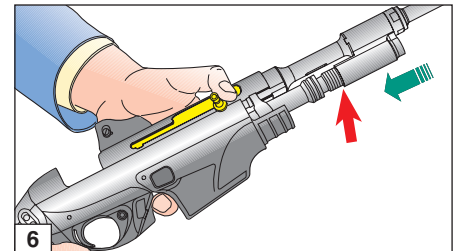
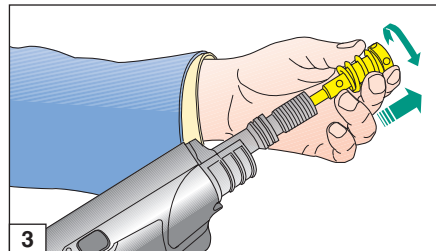
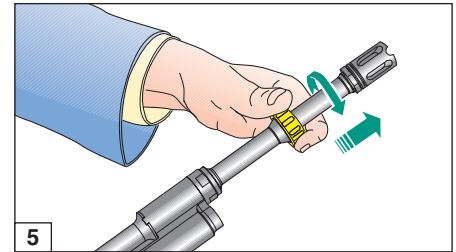
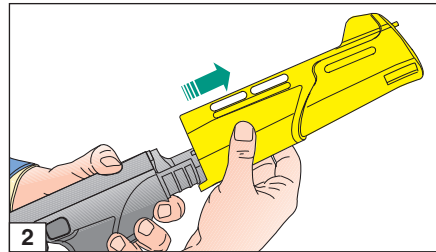
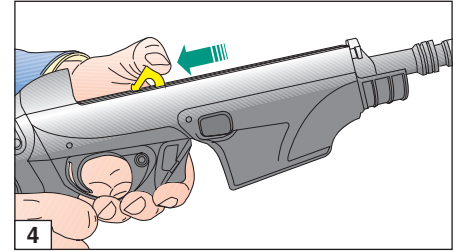
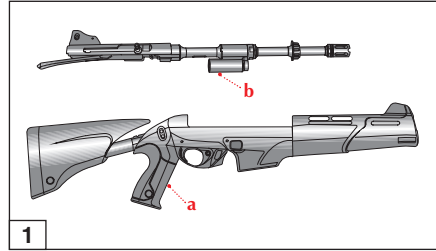



NOTE: the **pins** on the **piston** must be lined up with the relative pins (fig. 8).

- 6) Lodge the end part of the cover into the receiver and push all the way in until the whole unit clicks into place at stroke-end, and fits snugly (fig. 9).

WARNING: as the **bolt link** passes over the trigger guard it must fit itself into the **recoil spring tube** inside the receiver (fig. 10).

- 7) Fit the **barrel locking cap** to the end of the cylinder guide pin (fig. 11) and screw it on fully, using the **cap retaining pin** of the fore-end assembly (fig. 12).

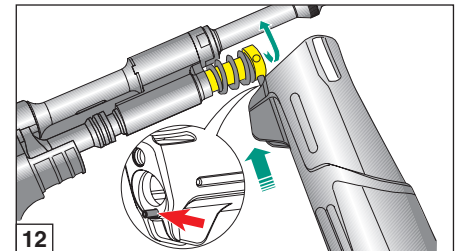
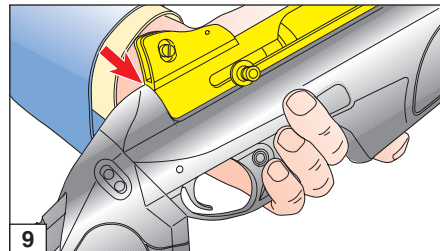
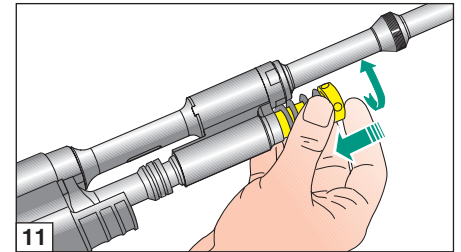
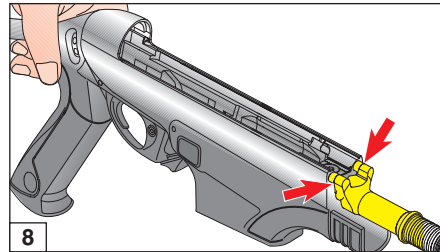
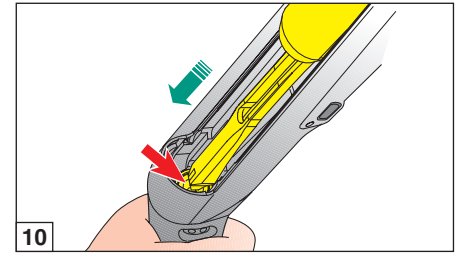
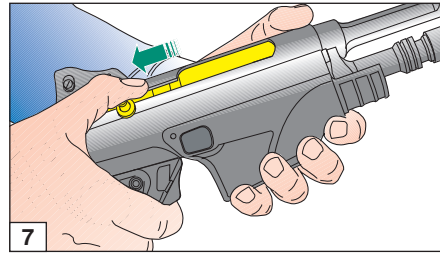



WARNING: use enough force when screwing on the cap to overcome the contrast of the spring stopping the barrel, until the cap is fully against the cylinder guide pin.

- 8) Slide **the fore-end** back on (fig. 13) and screw the **fore-end cap** back in (fig. 14).
- 9) Close **the bolt** by pulling it back and pressing the **no load lever** (fig. 15).

You have now finished assembling your rifle.

Use

Before beginning any operation whatsoever on your rifle, always make sure that chamber and magazine have been completely emptied!
(Carefully read loading and unloading instructions).

Rifle safety catch

Press the **safety button** on the trigger guard until its **red ring**, indicating firing position, is **no longer visible** (figs. 16-17).

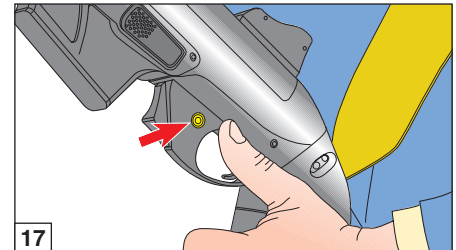
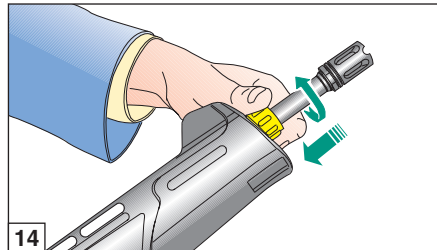
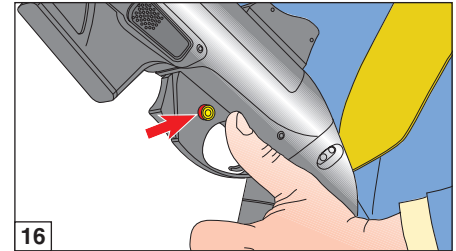
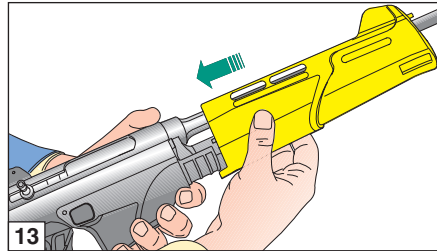
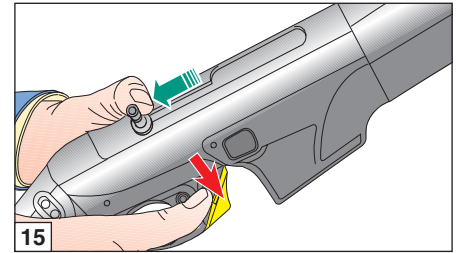



Loading

Before beginning any operation whatsoever on your rifle, always make sure that chamber and magazine have been completely emptied!
(Carefully read loading and unloading instructions).

NOTE: make sure that your rifle is fitted with a magazine containing a number of cartridges permitted by legislation in the country where you intend to use it.

Loading procedure

NOTE: the rifle's **safety catch** must be engaged (see previous "Rifle safety catch" point) and the **hammer cocked**. Take care to point the barrel in a safe direction.

- 1) **Open the bolt** (fig. 18).
- 2) Place a **cartridge** into the chamber (fig. 19).
- 3) Close **the bolt** by pressing the **no load lever** (fig. 15).

NOTE: the rifle is now loaded. If you want to fire off only one shot, you only need to press the safety catch into firing position (the red ring must be visible) and it is ready for firing.

- 4) In order to load the rifle completely, with the bolt closed, **release magazine** by pressing in the **release latch** (fig. 20).

NOTE: the **prismatic magazine** is automatically ejected by the rifle. Catch the magazine before it is released in order to avoid it falling.

- 5) Place **the cartridges** into the magazine (fig. 21).
- 6) **Slide the magazine** into its seat (fig. 22) making sure that it remains completely hooked in place.

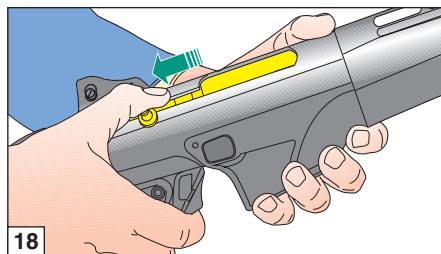

18

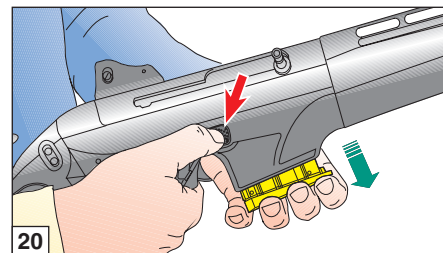

20

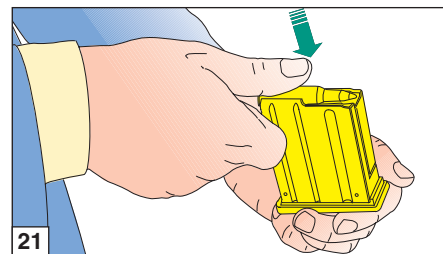

21

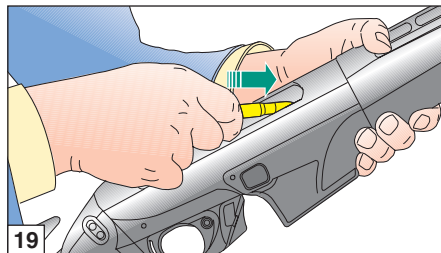

19

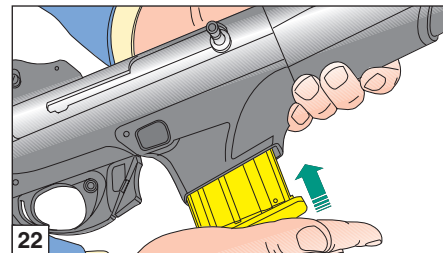

22



You have now **loaded the rifle**. Move the safety catch into firing position (**red ring is visible**) and you are ready to shoot.

Unloading procedure

(The following steps must be carried out with the safety catch engaged - see previous "Rifle safety catch" point and care must be taken to point the barrel in a safe direction).

Proceed as follows to unload rifle:

- 1) Unclamp **the magazine** (fig. 20).
- 2) Open **the bolt** (fig. 23): the cartridge in the chamber shall be extracted and ejected.
- 3) Carefully release **cocking lever** and close **the bolt** (fig. 24).
- 4) Remove **the cartridges** from the magazine (fig. 25) by pushing them forwards and fit the empty magazine back in.

Stripping of the rifle

(for maintenance and cleaning)

Before beginning any operation whatsoever on your rifle, always make sure that chamber and magazine have been completely emptied! (Carefully read loading and unloading instructions).

Stripping procedure

- 1) Open **the bolt** (fig. 18).
- 2) Unscrew **fore-end cap** completely (fig. 26) and slide off the **fore-end** (fig. 27).

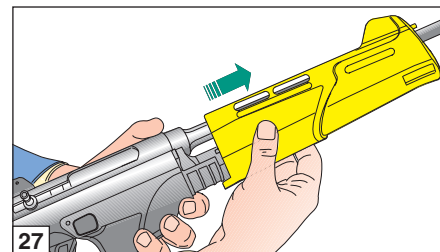
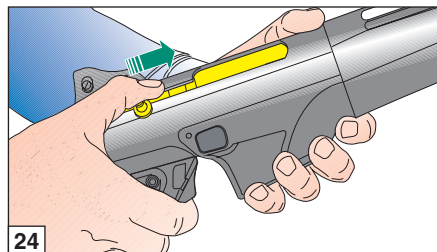
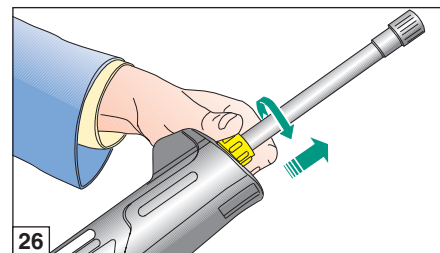
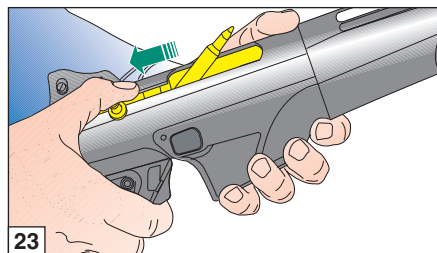
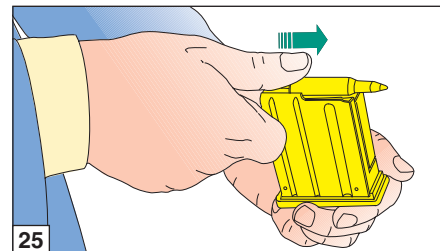



- 3) Fully unscrew **the barrel locking cap** (fig. 28), using **the cap retaining pin** of the assembly, if necessary.
- 4) Close **the bolt** back up by pressing in the bolt **lever** (fig. 15) and **remove the barrel-assembly** (fig. 29).
- 5) Take **the bolt** up to stroke end (fig. 30) and tear off **the arming bolt** (fig. 31).
- 6) Extend locking head and rotate and remove **bolt** (fig. 32).
- 7) Slide out the firing pin **retaining pin** whilst **keeping the firing pin** and firing pin **spring** in place (fig. 33).

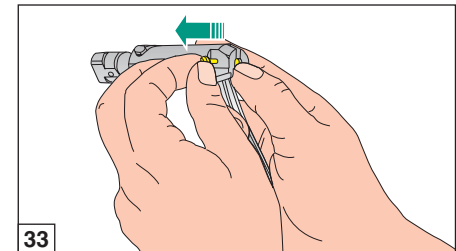
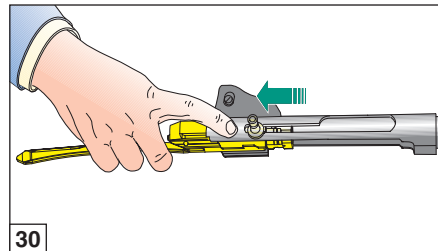
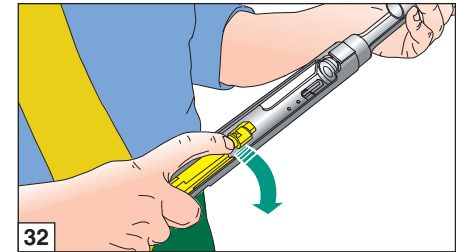
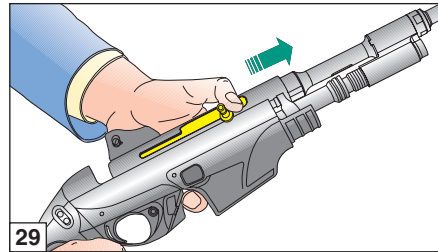
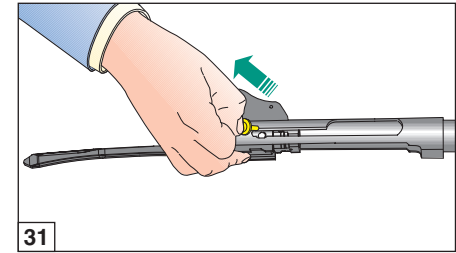
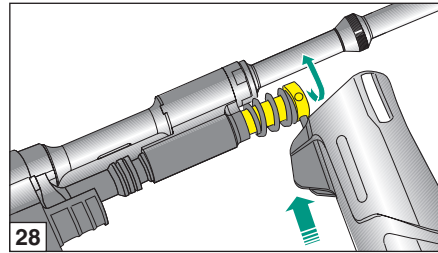

- 8) Remove **firing pin** together with relative **spring** from the bolt (fig. 34).
- 9) Remove locking head **pin** out of its slot (fig. 35).
- 10) Slide bolt **locking head** from the bolt (fig. 36).
- 11) Disengage **the magazine** (fig. 37).
- 12) Remove the **trigger guard pin** bushes from the **stock-receiver-fore-end** unit (fig. 38).
- 13) Remove the **trigger guard group** by rotating it upwards (figs. 39-40).

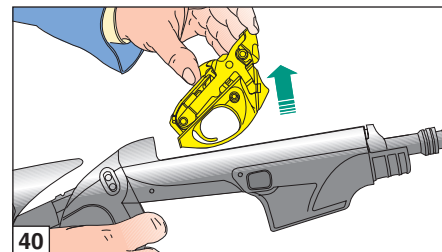
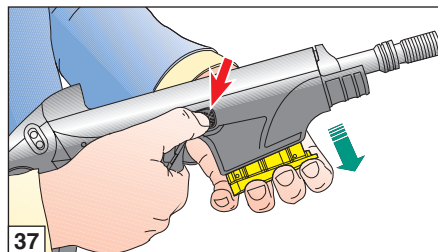
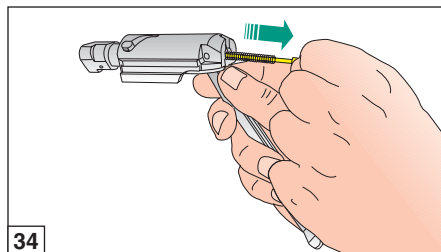
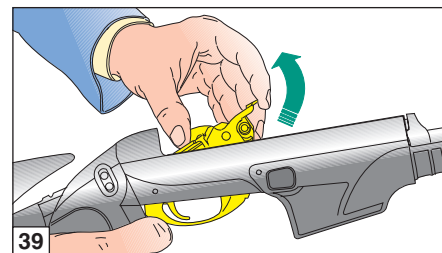
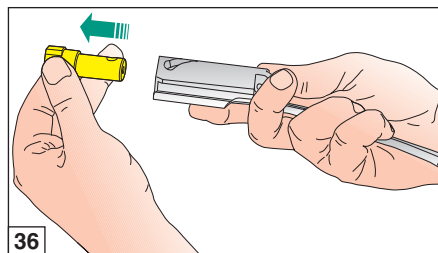
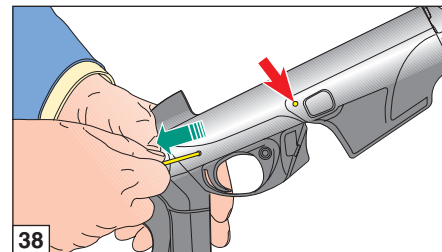
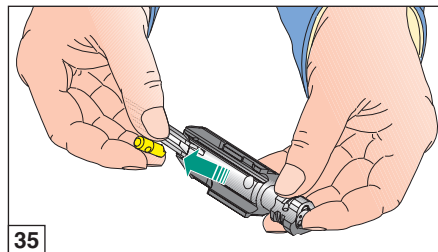



Maintenance

Before beginning any operation whatsoever on your rifle, always make sure that chamber and magazine have been completely emptied!

(Carefully read loading and unloading instructions).

Thanks to its extremely simple design and accurately chosen materials, the MR1 rifles **do not require** special maintenance.

We nevertheless **recommend** the following:

- 1) routine **cleaning of the barrel** after use;
- 2) periodically clean and lubricate the firing mechanism (hammer, trigger and magazine) to avoid clogging with **powder residuals** (or other foreign matter);
- 3) **the bolt group** also risks clogging for the same reasons and therefore must also be dismantled, cleaned and lubricated;
- 4) periodically clean the piston and the gas collector cylinder;
- 5) to keep the rifle in good order we recommend lubrication of any of the **parts subject** to atmospheric corrosion.

For a proper maintenance of your firearm, **use Benelli cleaning kit and oil Benelli** (fig. 41) (*not supplied*).

Benelli oil is recommended for lubricating and protecting mechanical parts (receiver, bolt and barrel).

Benelli recommends use of specific products for cleaning other parts (technopolymer, camouflage or painted stock and fore-end). Avoid that parts get in contact **with oils containing solvents or chemical substances in general, which could alter or damage their surfaces.**

N.B.: valve and piston do not require lubrication.

The gas collector cylinder is fixed to the barrel through the retaining ring nut (fig. 42).

WARNING: improper use or dismantling of the ring nut on behalf of the user leads to loss of warranty.

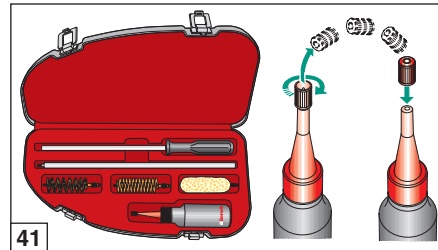

41

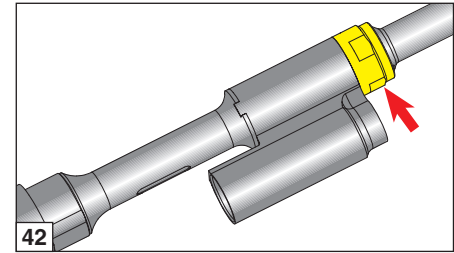

42

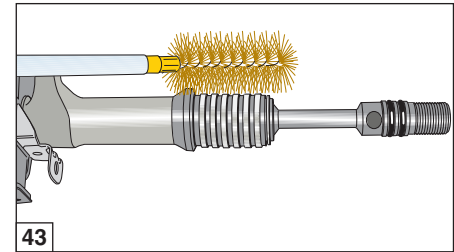

43

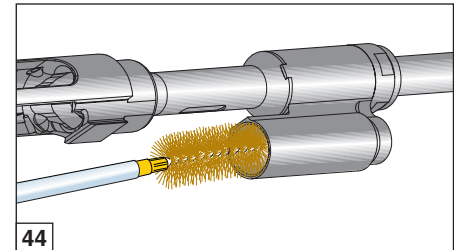

44

Cleaning the gas collection system

(figs. 43-44)

WARNING: some ammunition uses powders with a specific make-up that tends to create significant deposits of combustion residues inside the gas collector.

The gas collector is located back in the barrel, thereby facilitating the automatic cleaning of combustion residues after each firing cycle.

These residues may, in any case, become denser, particularly after a long period in which the weapon has not been used, with the consequent risk of piston blockage.

Where the weapon is not used for a long time, and in any case at the end of the hunting season, please clean the gas collector as follows:

- 1) Dismantle the barrel and piston (see dismantling procedure on page 9).
- 2) Carefully clean the piston, the piston guide, the elastic bands and the inside of the cylinder with a bronze cleaning rod.
- 3) Check that the piston slides freely and that the holding elastic bands are free to oscillate on the piston.

WARNING: do not lubricate the piston and the inside of the cylinder. Oil can lead to the accumulation of combustion residues.

For any servicing whatsoever, please contact the nearest Benelli Technical Assistance Center.

Rifle assembly

WARNING: the version here shown comes with telescoping stock. Independently from stock type all assembly phases of the components remain unchanged.

For correct assembly of the rifle after maintenance, proceed as follows:

- 1) Fit the whole **trigger unit, with cocked hammer and safety catch engaged**, onto the receiver; position it so that it is the front end that **comes into contact** with the receiver (figs. 45-46).
- 2) Push in the trigger guard **pin bush** (figs. 47-48).

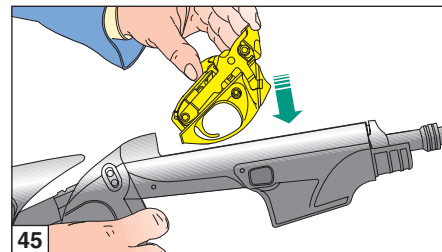

45

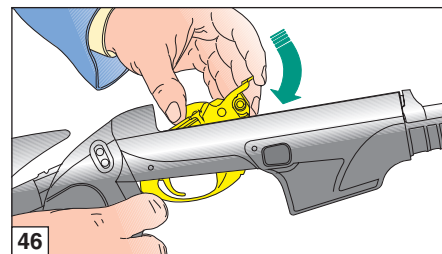

46

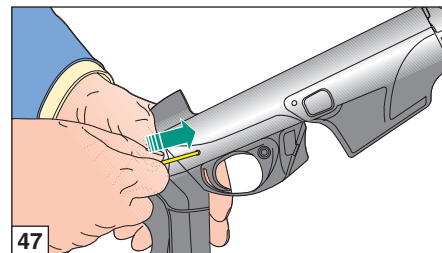

47





- 3) Slide the **locking head** into the bolt making sure that the hole on the stem coincides with the bolt **slot** (fig. 49).
- 4) Fit the locking head **pin** into its hole on the locking head stem through the slot on the bolt (figs. 50-51).
- 5) Fit the **firing pin** and the firing pin spring into the slot on the bolt (fig. 52).

NOTE: always double check to make sure that the firing pin spring is in place.

- 6) Assemble the firing pin **retaining pin** into its slot so that the firing pin is locked into place (fig. 53).

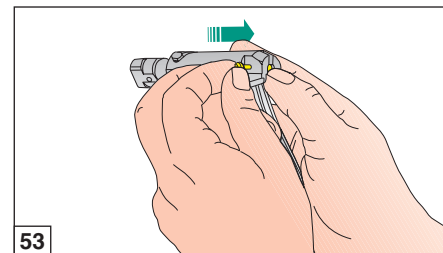
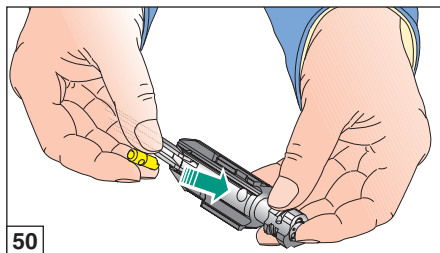
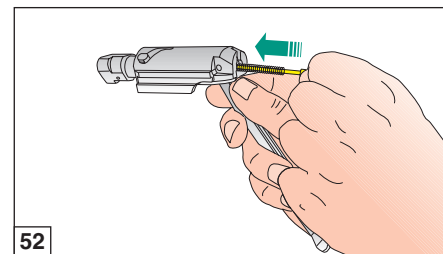
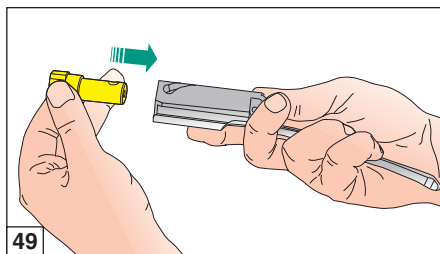
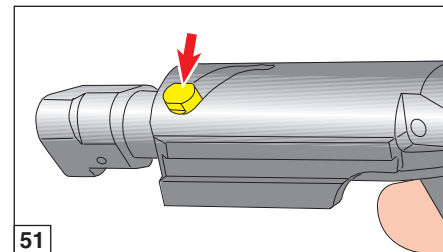
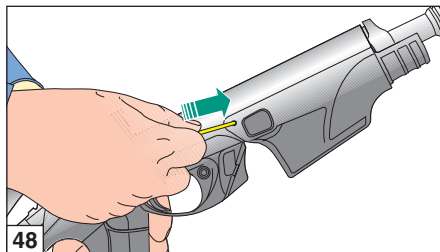



WARNING: if both **firing pin** and relative **locking pin** have been assembled correctly, the firing pin must appear **as shown** in figure 54.

NOTE: **do not** use any type of **tool** for the insertion of the firing pin into the bolt carrier: **only use your fingers!**

- 7) Grip **the bolt**, making sure that you **keep the head's** position extended (fig. 55).
- 8) Place **the bolt** into position as illustrated (fig. 56) and **slide it forward** until the bolt lever seat is aligned with the end of the slot (fig. 57); push **the bolt lever** into its hole (fig. 58).
- 9) **To finish** rifle assembly, follow all the steps given after step 3 at page 5.

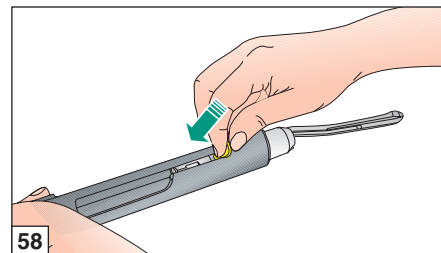
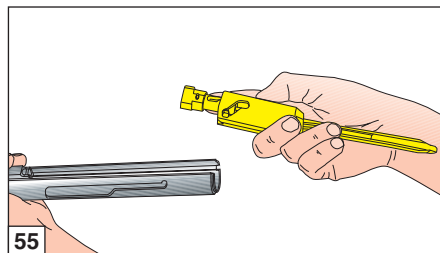
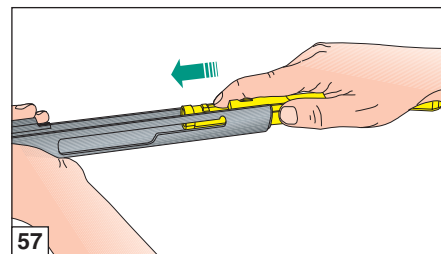
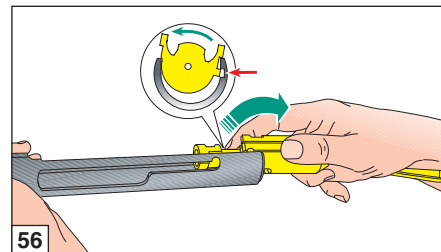
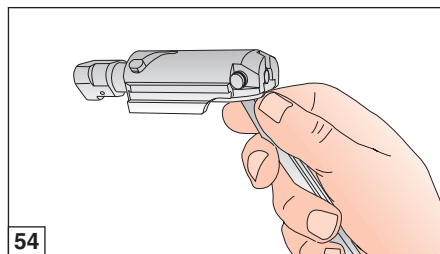



Stock disassembly and assembly

Three fixed drop stock versions are available:

- 1) telescoping stock
- 2) standard stock
- 3) Pistol Grip stock

Stock disassembly

1 - Telescoping stock (fig. 59)

- 1) Press **the lock button** (fig. 60) and move the stock back as far out as it will go (fig. 61).
- 2) Press **the lock button** using more force to remove the stock completely (fig. 62).
- 3) As for grip disassembly unscrew the retaining ring nut by using the fore-end cap stop pin or a 5 mm diam. pin punch (fig. 63).
- 4) Slide off the grip from the recoil spring tube.

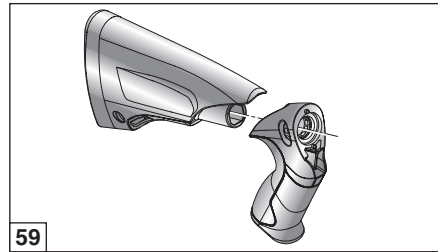

59

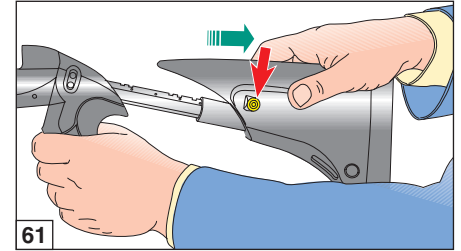

61

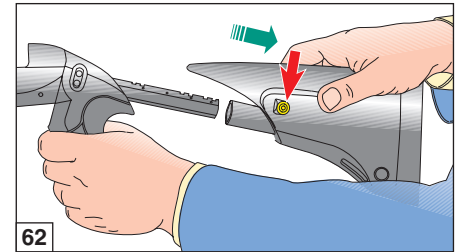

62

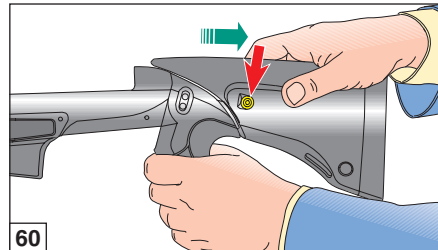

60

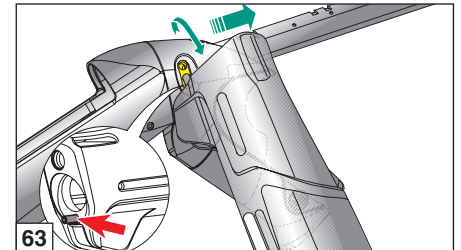

63

2 - Hunting stock (fig. 64)

- 1) Press on the **buttpad** and simultaneously exert a movement from below upwards (figs. 65-66).
- 2) Using a 13 mm socket wrench, **slacken the stock screw**, which is accessible from the rear after removal of the buttpad (fig. 67).

WARNING: whilst completely removing the stock screw, take care not to lose the **spring washer**. This may easily happen as it is no longer withheld by the nut itself (fig. 68).

- 3) **Completely remove** the stock by sliding it off along the recoil spring tube (fig. 69).

WARNING: take care not to lose the adaptor (fig. 69).

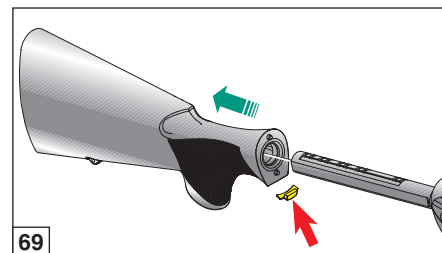
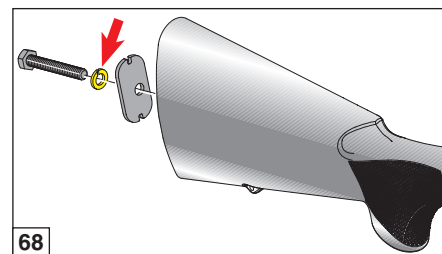
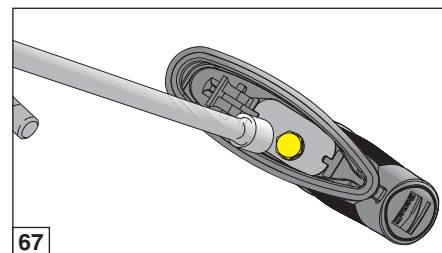
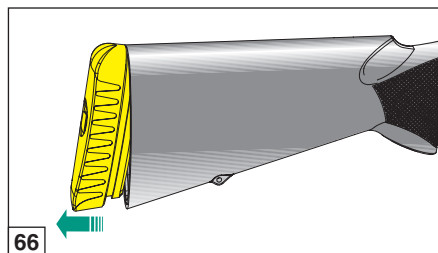
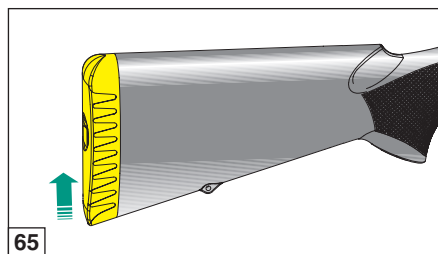
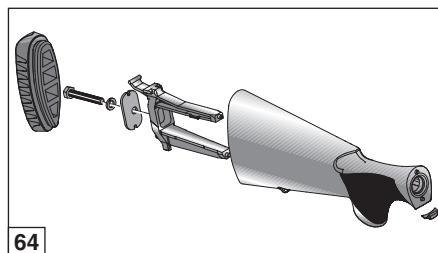



3 - Pistol Grip stock (fig. 70)

- 1) Press on **the buttpad** and simultaneously exert a movement from below upwards (figs. 71-72).
- 2) Using a 13 mm socket wrench, unscrew **the stock nut**, which is accessible from the rear after removal of the buttpad (fig. 73).

WARNING: whilst completely removing stock screw, take care not to lose the **spring washer**. This may easily happen as it is no longer withheld by the screw (fig. 74).

- 3) **Completely remove** the stock by sliding it off along the recoil spring tube (fig. 75).

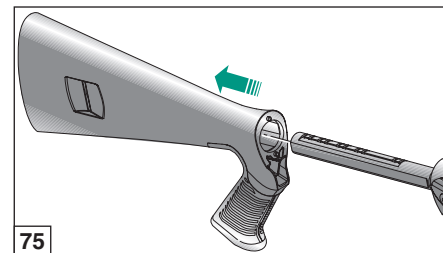
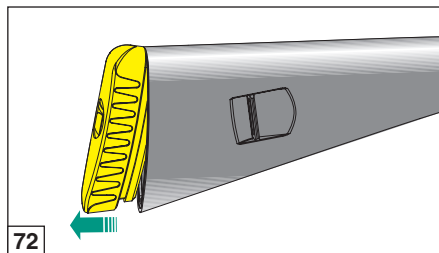
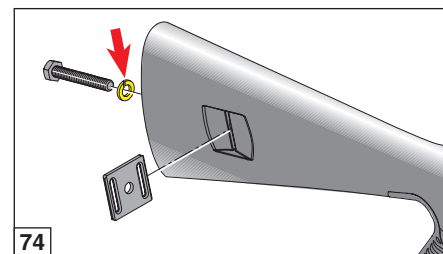
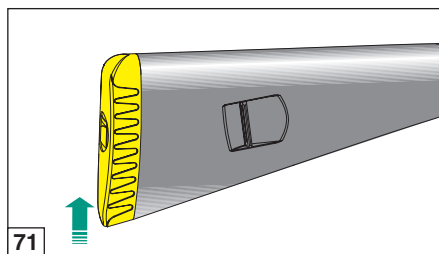
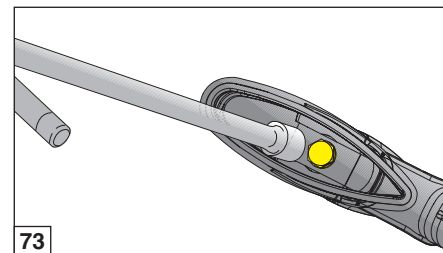
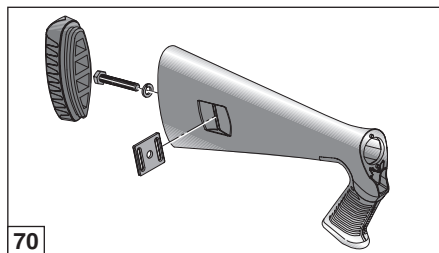



Stock assembly

1 - Telescoping stock

- 1) For grip assembly, slip it into the recoil spring tube and tighten the retaining ring nut (figs. 76-77).
- 2) Install the telescoping stock (fig. 78), pressing firmly on the lock button and sliding the stock onto the recoil spring tube at the same time.

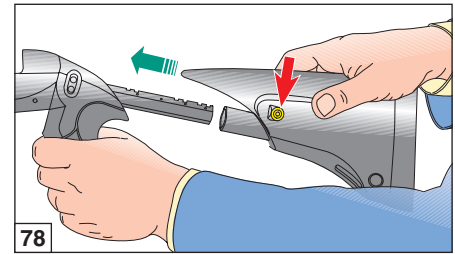

2 - Hunting stock

- 1) **Remove the buttpad** from the optional pistol-grip stock as described in fig. 66.
- 2) Insert the adaptor in the right position and point the rifle towards the ground and install the pistol-grip stock over the **recoil spring tube** (fig. 79).

WARNING: if correctly assembled, the stock will come into contact with the rear part of the receiver.

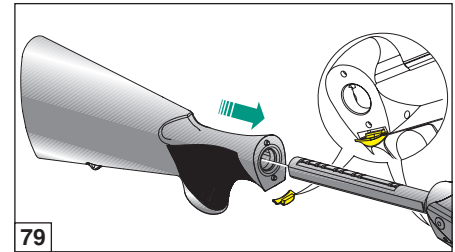
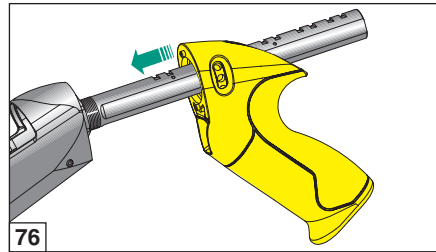

- 3) Correctly place **the stock locking plate** in its seat, inside the stock (fig. 80).
- 4) Assemble the spring washer on the stock screw and then screw it on the recoil spring tube (fig. 80).

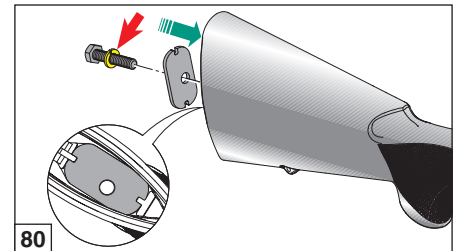
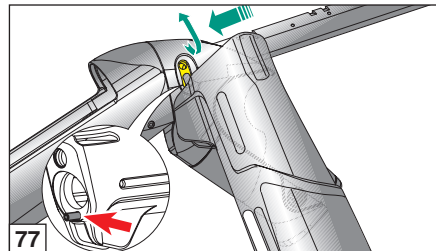



- 5) Energetically press the stock to the rifle, screwing the stock screw using a 13 mm wrench (fig. 81).
- 6) Assemble the buttpad, pressing it energetically against the stock in order to push it into its seat (fig. 82).

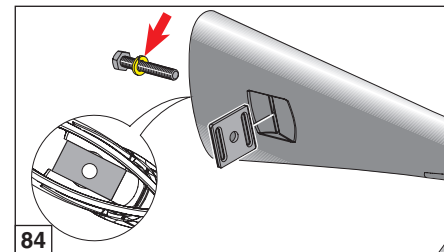
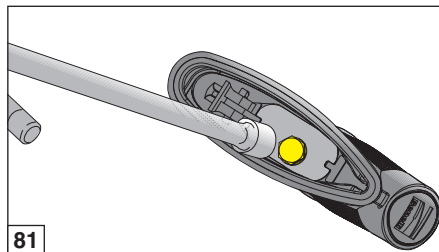

3 - Pistol Grip stock

- 1) **Remove the buttpad** from the optional pistol-grip stock as described in fig. 72.
- 2) Pointing the rifle towards the ground, fully insert the stock onto **the recoil spring tube** (fig. 83).
- 3) Install the **swivel plate** (supplied with the pistol grip type stock) on its seat, keeping it in a central position (fig. 84).

WARNING: if correctly assembled, the stock will come into contact with the rear part of the receiver.

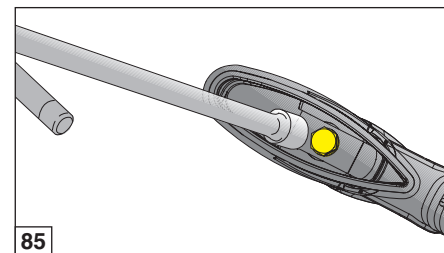
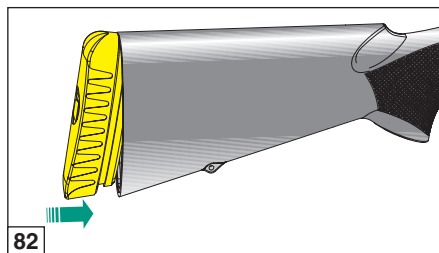

- 4) Assemble the spring washer on the stock nut and then screw it on the recoil spring tube (fig. 84).
- 5) Energetically press the stock to the rifle, screwing the stock nut using a 13 mm wrench (fig. 85).

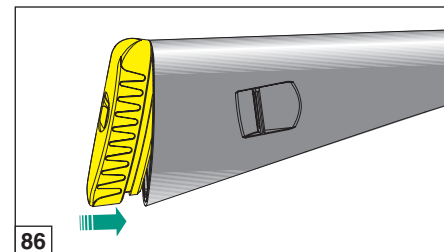
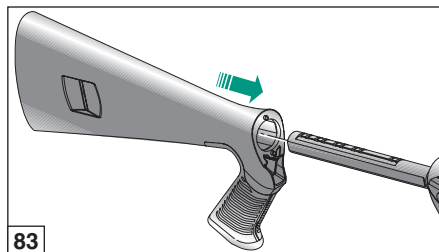



- 6) Assemble the buttpad, pressing it energetically against the stock in order to push it into its seat (fig. 86).

GENERAL WARNING: once the stock has been replaced, make sure that it is correctly fixed to the receiver. After having fired the first few rounds, check everything again and if necessary, remove the buttpad once again and by means of the appropriate wrench, tighten stock nut further.

Troubleshooting

Before beginning any operation whatsoever on your rifle, always make sure that chamber and magazine have been completely emptied!

(Carefully read loading and unloading instructions).

If the rifle fails to fire

- 1) **Check the safety catch:** if it is engaged, push the button into firing position.
- 2) **Check that there is a cartridge in the barrel:** if not, insert a cartridge as per loading instructions (page 8).
- 3) **Check firing mechanism:** if necessary, clean and lubricate.
- 4) **Check the gas system:** the piston must freely move inside the cylinder. If necessary proceed with cleaning, (page 13).

Barrel locking cap

Especially after having fired the first shots, make sure that the barrel locking cap is tightly screwed onto the receiver, so that **the barrel is completely locked on.**

Choice of ammunition

All cartridges having a calibre that equals the calibre given on the rifle barrel may be used for your MR1, provided they conform to CIP regulations.

Non-compliance to this rule would have serious consequences both for the shooter and for the rifle.

NOTE: use of not correctly refilled cartridges may cause damages to both the barrel and the lock, with possible consequences for the shooter as well.

All the MR1 rifles are subjected to a burst test at the Italian National Proof House in Gardone Valtrompia (Brescia), conform to CIP regulations.





Rear sight adjustment

The rear sight can be adjusted for both windage and elevation if the standard factory setting does not meet shooter requirements.

Before beginning any operation whatsoever on your rifle, always make sure that chamber and magazine have been completely emptied!

(Carefully read loading and unloading instructions).

Windage adjustment

Using a coin or the rim of a shell cartridge to rotate the **windage adjustment screw** (fig. 87), located on the right side of the rear sight assembly, in the desired direction.

Rotating the windage adjustment screw in a **counter clockwise** direction moves the point-of-impact on target to the left, in a **clockwise** direction moves the point-of-impact to the right. **Note on the windage scale**, the amount of adjustment made (fig. 88).

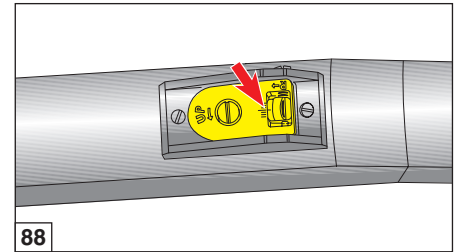
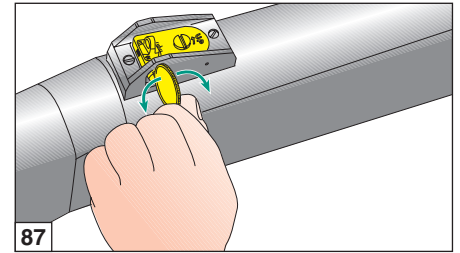

Elevation adjustment

Use a coin or the rim of a shell cartridge to rotate the **elevation adjustment screw** (fig. 89), located on top of the elevating platform, in the desired direction.

Rotating the elevation screw in a counter clockwise direction raises the aperture and the point-of-impact of on target, in a clockwise direction lowers the aperture and point-of-impact on target. Note on the elevation scale on the rear surface of the elevating platform the amount of adjustment made, or count the tactile clicks of the screw.

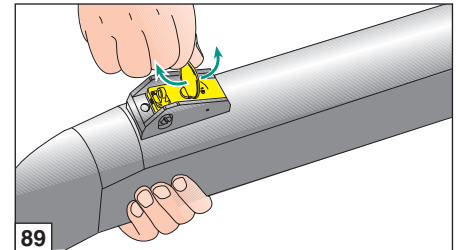



Spare Parts



To order spare parts you must specify the gauge, the model and the serial number of your shotgun.

Part numbers here listed refer to respective drawings.



Drawing 1

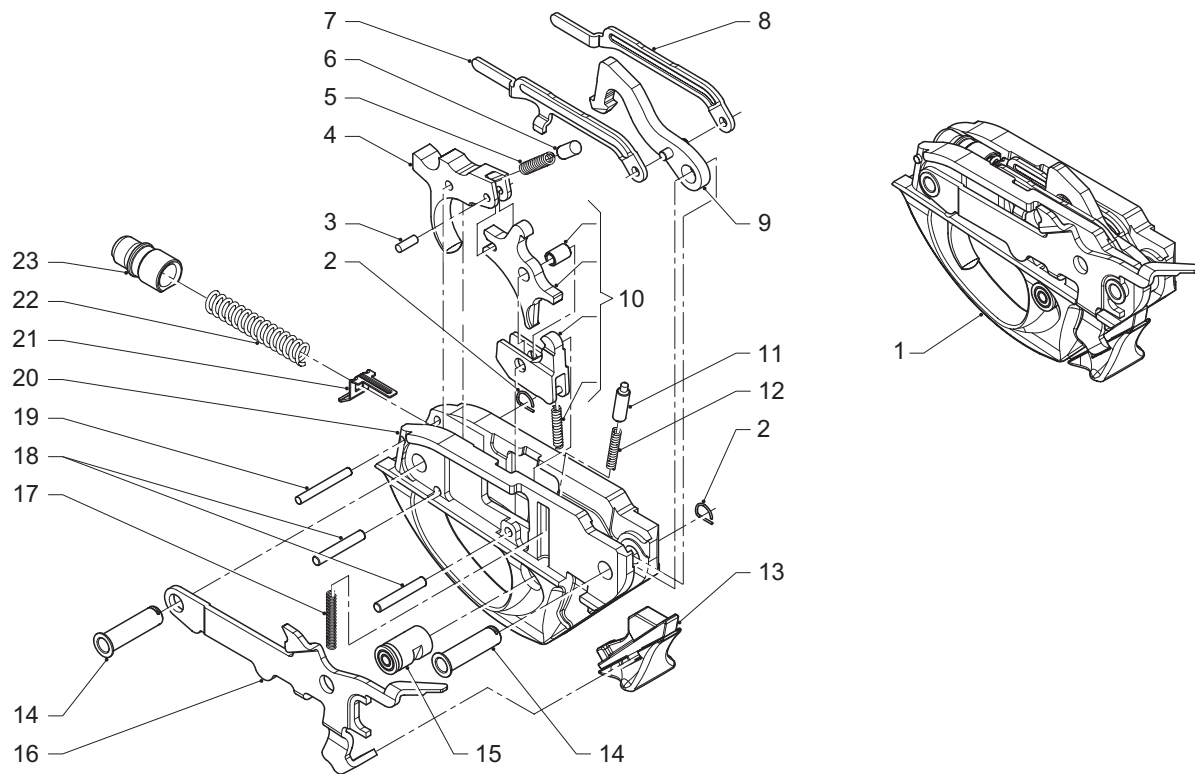



Pos. No.	Code	Description
1	001V	Trigger guard assy
2	018A	Spring
3	285W	Pin
4	009V	Trigger
5	025P	Spring
6	024P	Pin
7	281W	Hammer link (R.H.)
8	444W	Hammer link (L.H.)
9	002V	Hammer
10	443W	Disconnecter assy
11	008W	Safety plunger pin
12	007J	Safety spring
13	410V	Lever button
14	016W	Pin bush
15	013V	Hand safety button
16	219V	No-load indicator lever
17	220W	Spring
18	010W	Trigger pin
19	306W	Trigger pin
20	014W	Trigger guard
21	215V	Disconnecter
22	004V	Spring
23	003V	Cap

Pos. No.	Code	Description
----------	------	-------------





Drawing 2

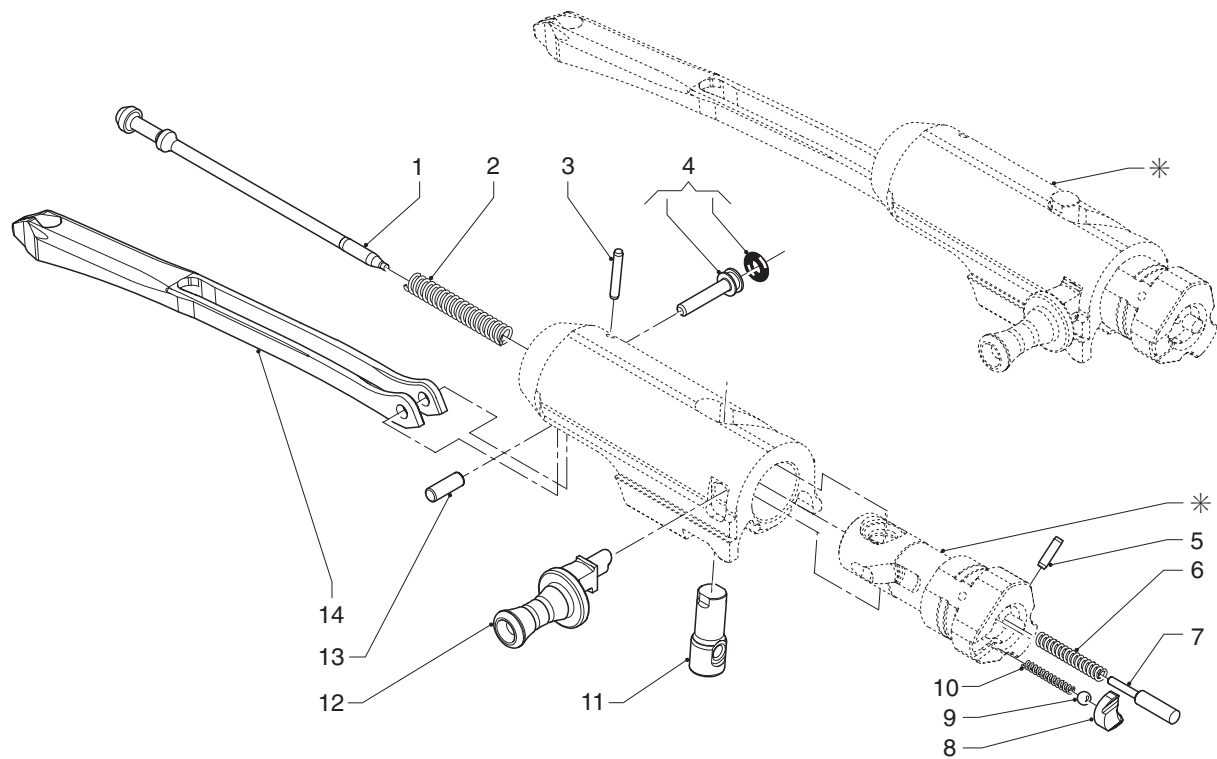



Pos. No.	Code	Description
1	025V	Firing pin
2	037V	Spring
3	035A	Pin
4	028A	Firing pin retaining pin
5	411V	Pin
6	046W	Ejector spring
7	045V	Ejector
8	034A	Extractor
9	074C	Extractor castor
10	033V	Spring
11	031V	Pin
12	030V	Bolt handle
13	029W	Link pin
14	027W	Link
*		Item not for sale separately from the barrel

Pos. No.	Code	Description
----------	------	-------------





Drawing 3

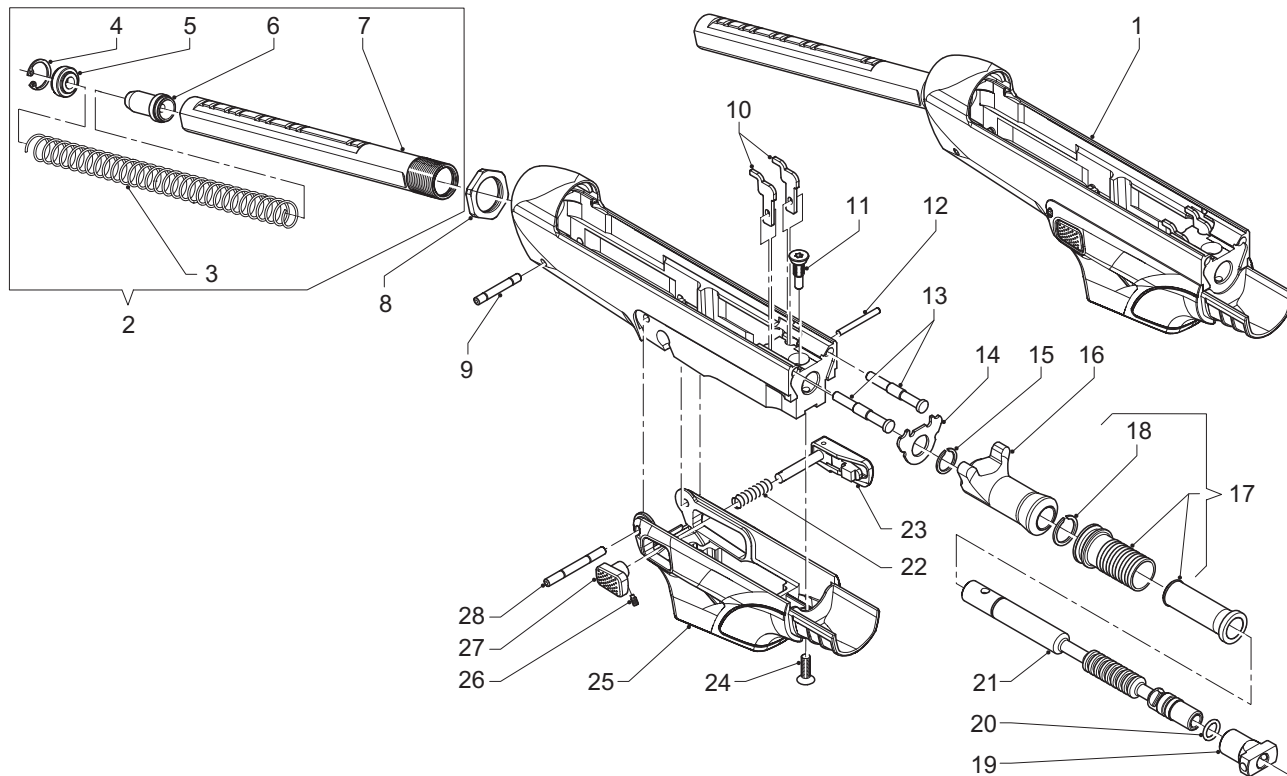



Pos. No.	Code	Description
1	059V	Receiver assy + recoil spring tube
2	166V	Recoil spring tube assy
3	054V	Spring
4	052J	Circlip
5	050J	Screw
6	055W	Recoil spring plunger
7	049V	Recoil spring tube
8	075J	Ring nut
9	015W	Pin
10	407V	Magazine plate
11	295V	Screw
12	413V	Roller
13	269W	Pin
14	088V	Plate
15	298V	Circlip
16	412V	Piston
17	399V	Extension assy
18	302W	Circlip
19	069V	Cap
20	270W	O-ring
21	066V	Pin
22	283V	Spring
23	282V	Catch lever assy
24	414V	Screw

Pos. No.	Code	Description
25	408V	Magazine carrier
26	403V	Grub screw
27	402V	Unlock button
28	396V	Pin





Drawing 4

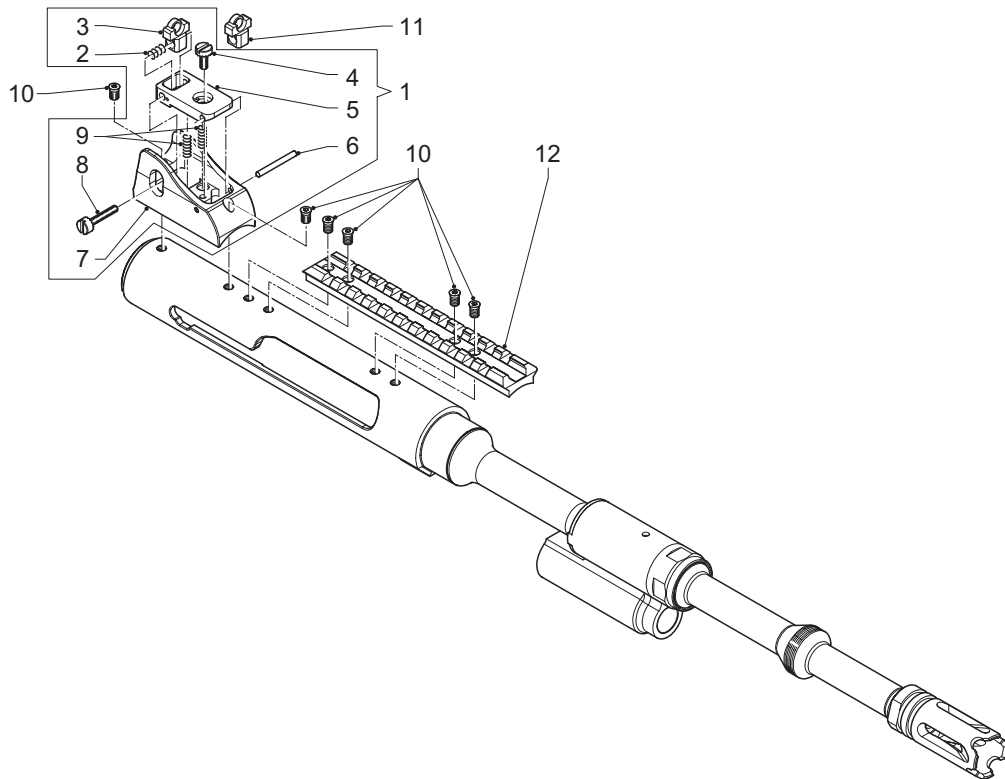



Pos. No.	Code	Description
1	127V	Rear sight assy
2	258J	Spring
3	253J	Rear sight aperture Ø 5
4	255J	Screw
5	254J	Support
6	257J	Pin
7	126V	Rear sight support
8	256J	Screw
9	259J	Spring
10	128W	Torx screw
11	253V	Rear sight aperture Ø 1,5
12	260V	Telescope support

Pos. No.	Code	Description
----------	------	-------------





Drawing 5

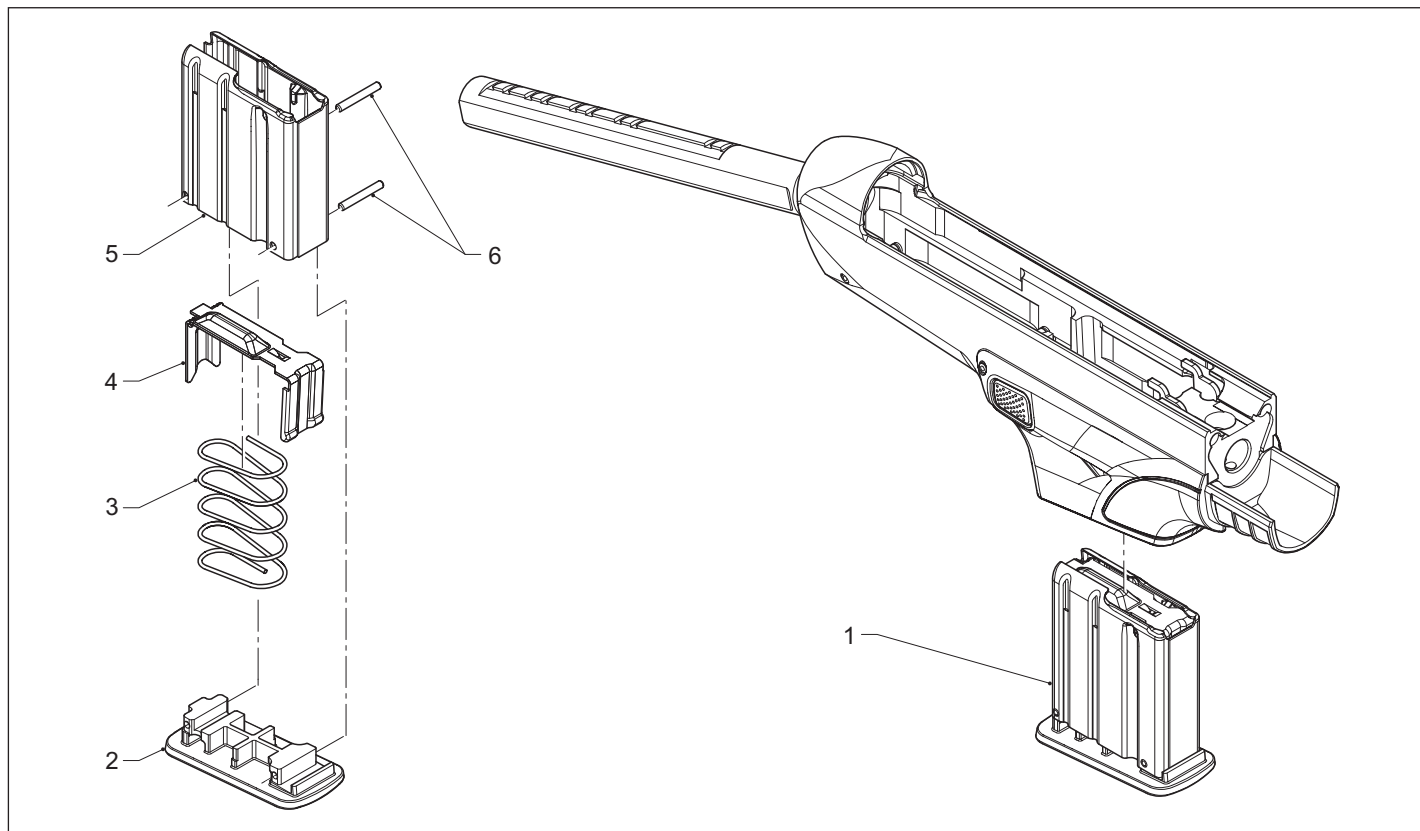



Pos. No.	Code	Description
1	307V	Magazine assy
2	102V	Magazine follower rest
3	035V	Spring
4	100V	Magazine follower
5	097V	Magazine body
6	010A	Pin

Pos. No.	Code	Description
----------	------	-------------





Drawing 6

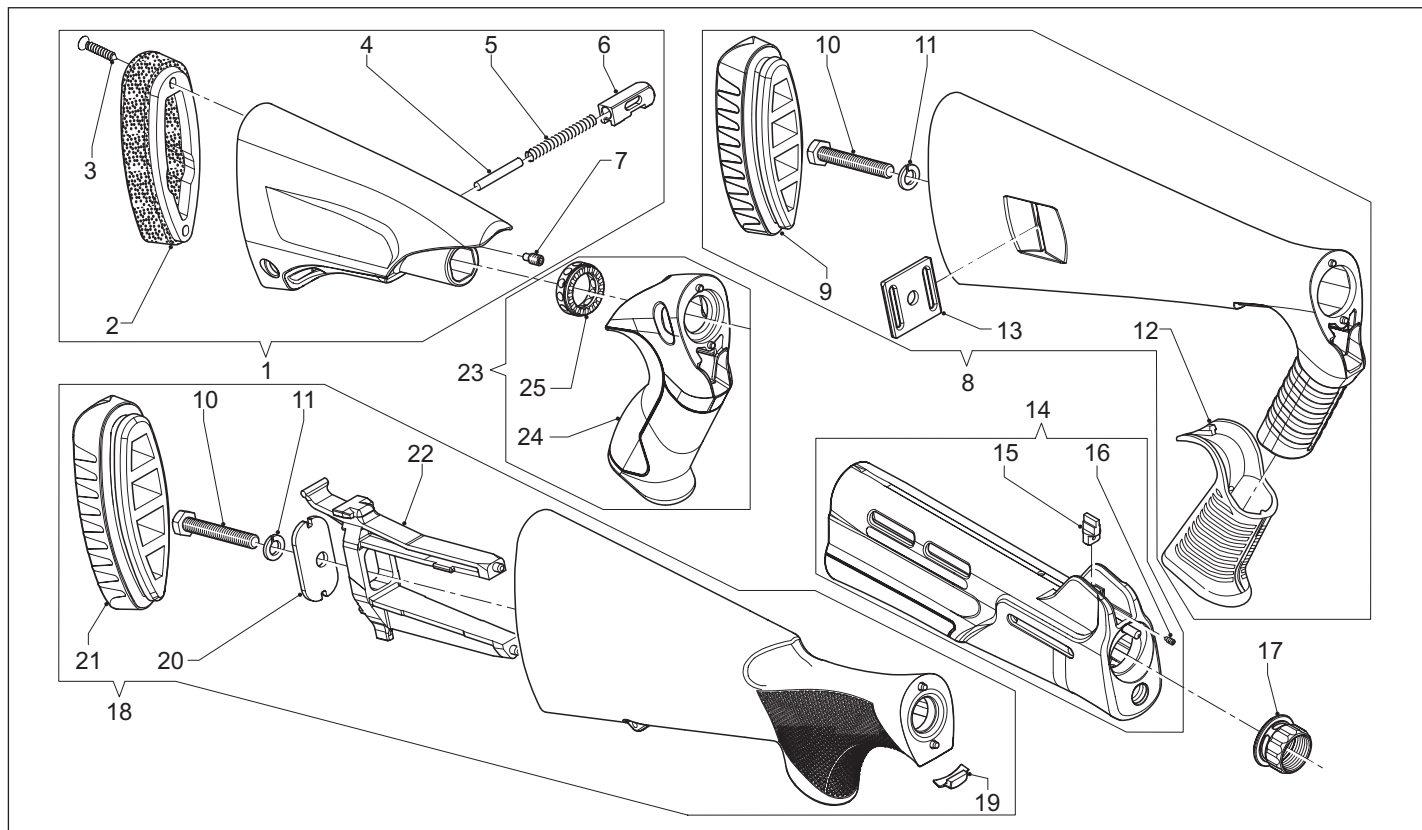



Pos. No.	Code	Description
1	265S	Telescoping stock assy
2	061C	Butt plate
3	062C	Screw
4	395S	Stock clickstop pin
5	004A	Spring
6	108S	Button
7	224N	Grub screw
8	265V	Pistol-grip stock assy
9	151T	Rubber butt plate
10	053V	Screw
11	052A	Seeger ring
12	083C	Grip
13	063C	Swivel plate
14	174V	Fore-end assy
15	110V	Front-sight
16	403V	Grub screw
17	146V	Fore-end follower
18	159V	Synthetic stock assy
19	442V	Adaptor (trigger-stock)
20	150W	Locking plate
21	151N	Rubber butt plate
22	149C	Spacer
23	117V	Pistol grip handle assy
24	083V	Grip

Pos. No.	Code	Description
25	075S	Nut

